

Materials Required To Build 1 set of Pits

ITEM NO.	COMPONENT NAME	StockSize	COMPONENT MATERIAL	#REQ'D
1	4x4	3.500 x 3.500 x 79.000 -	Pressure Treated Lumber	4
2	4X4	3.500 x 3.500 x 72.000 -	Pressure Treated Lumber	4
3	2X4	1.500 x 3.500 x 72.000 -		4
4	Ballister	18.000 x 1.500 x 1.500 -	Pressure Treated Lumber	4
5	Walkway	2.7 Cubic Feet -	Concrete	4
6	Wire Fence	17.000 x 0.110 x 72.060 -	Steel	4
7	Sand	36.000 x 3.500 x 72.000 -	Sand	0
8	Hot Galvanized Lag Screws	3/8 Lag 8in. Long	Steel	16
9	For Setup 2x4	16.500 x 3.500 x 1.500 -	Pressure Treated Lumber	2
10	Stake Anchor	24.000 x 12.000 x 12.000 -	Railroad Tie	2
11	Stake	1 Dia. x 36" Long -	Hot Rolled Steel	2
12	Angle Iron	2.000 x 1.000 x 1.000 -	Steel	2

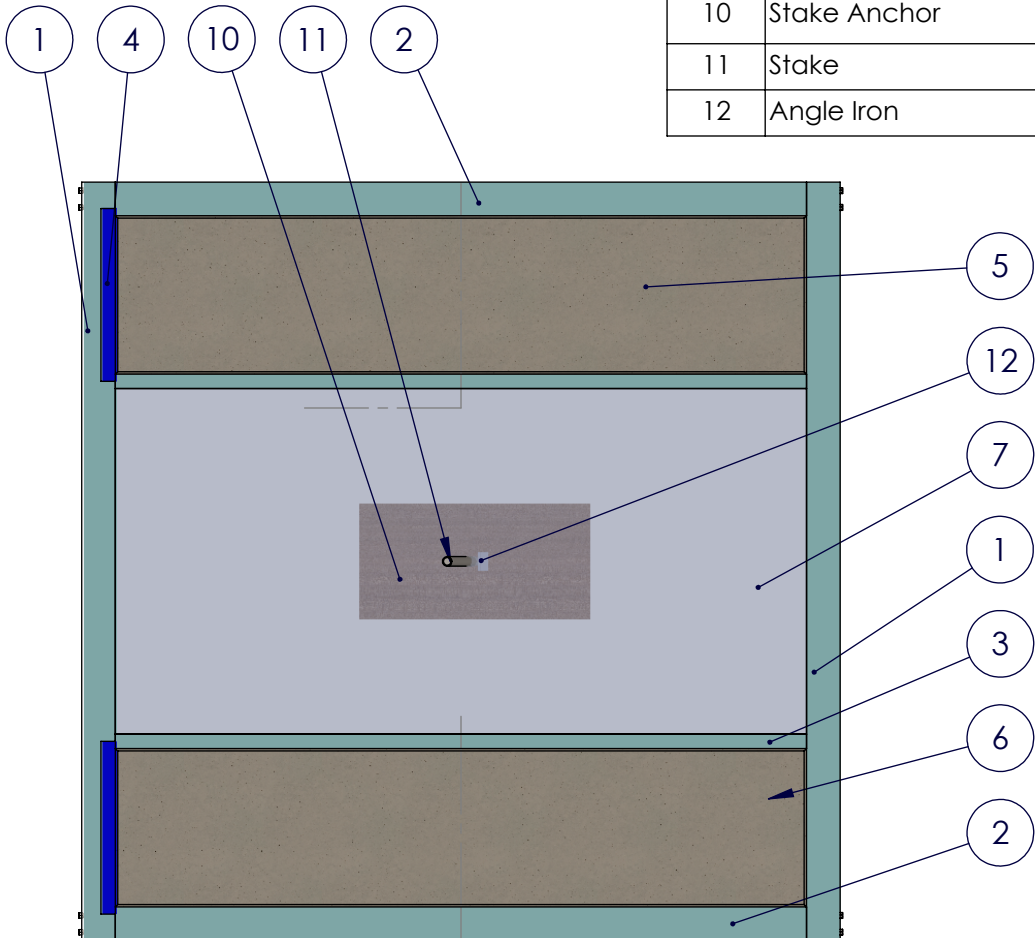

Tools Required to build and set up pits:

- Access to a welder (weld angle iron to stake)
- Wired Electric Drill (for driving Lags)
- Electric Cement mixer (rental)
- Cordless Drill
- 1/4 drive Socket and ext. to fit in drill chuck (to drive lags)
- 4 Ft. Level
- String Level
- String
- Flat Shovel
- Round Shovel
- 2-1/2" Drywall screws (Stainless Steel)
- Pin Setting tool (optional)

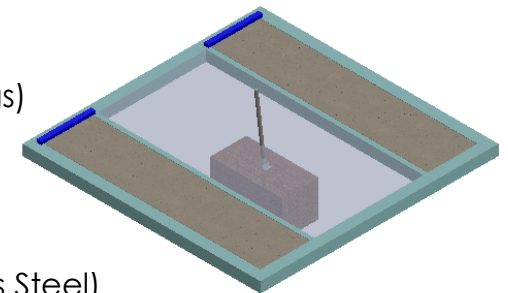

All Dimensions are in Inches

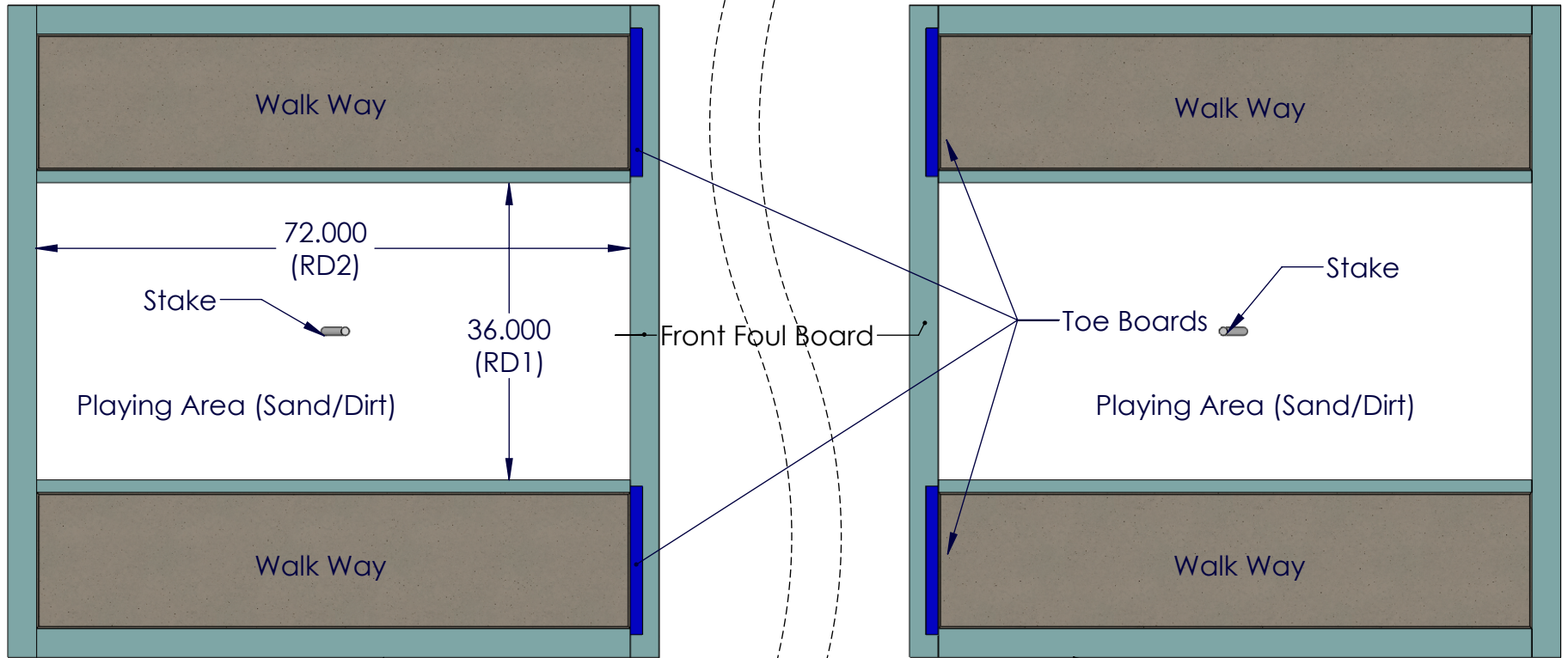
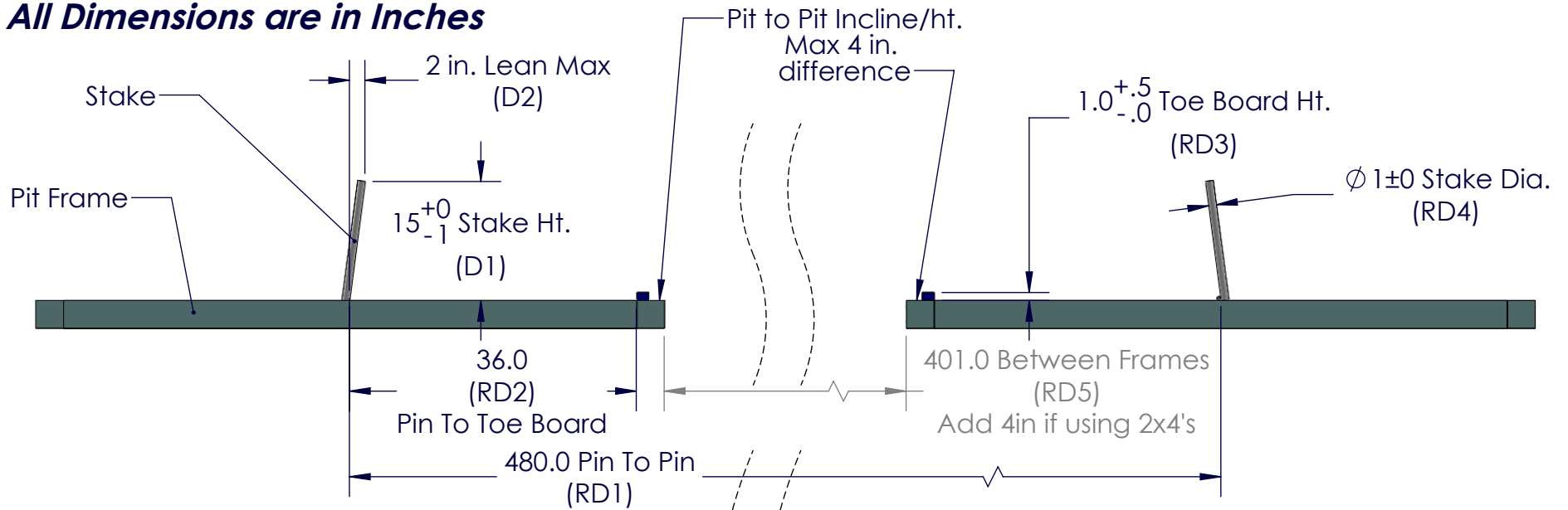

Note: Use a 50ft pc of string to align the frames together

Outer Frame Assembly

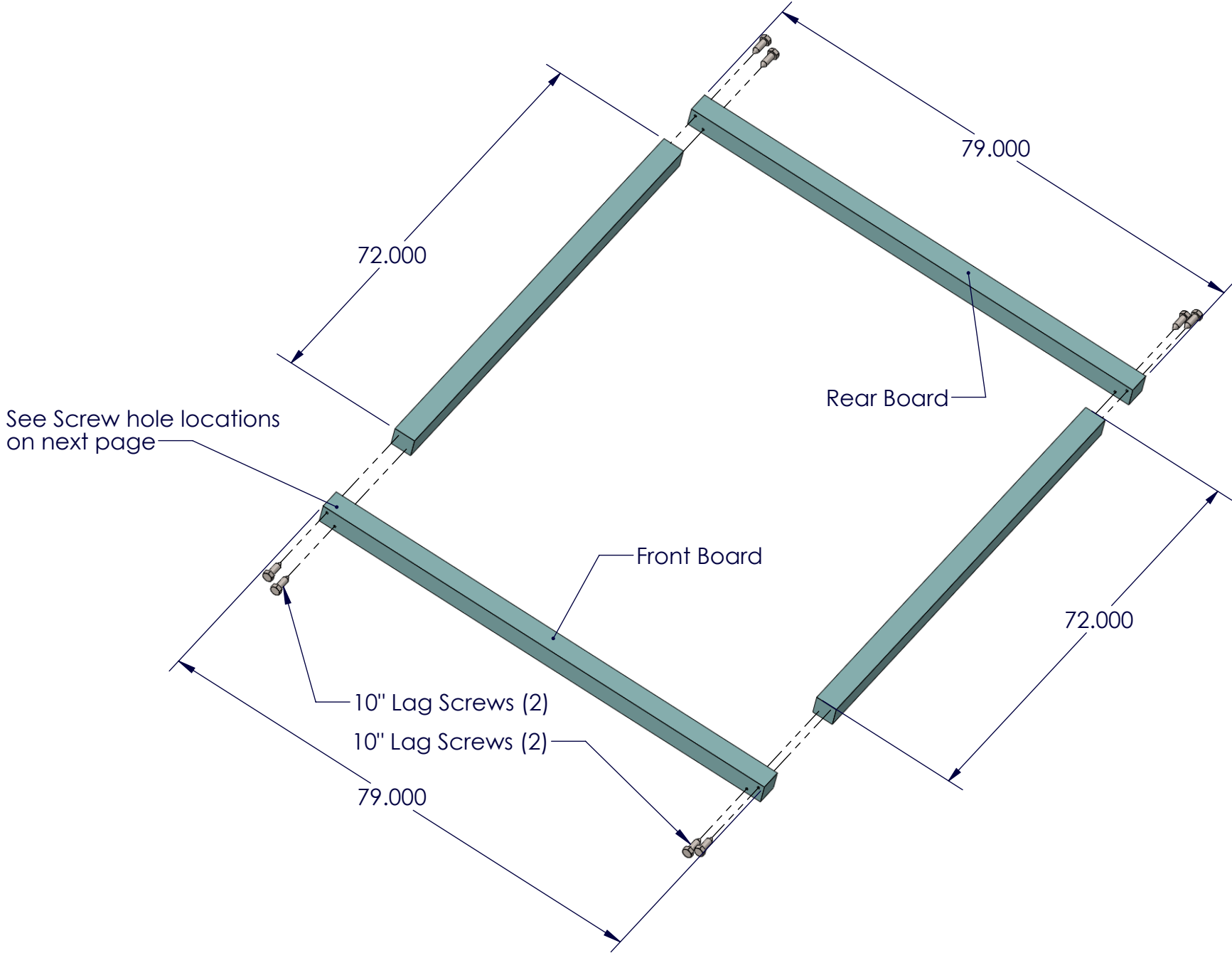

72.000

79.000

Rear Board

Front Board

72.000

79.000

See Screw hole locations on next page

10" Lag Screws (2)

10" Lag Screws (2)

1. Drill 2 3/8 dia Thru holes at both ends of both the front and back 4x4's (# 1's). like shown below, be sure all holes are on the same side of each 4x4.

2. Assemble 2 (#1's) and 2 (#2's) as shown to the right.

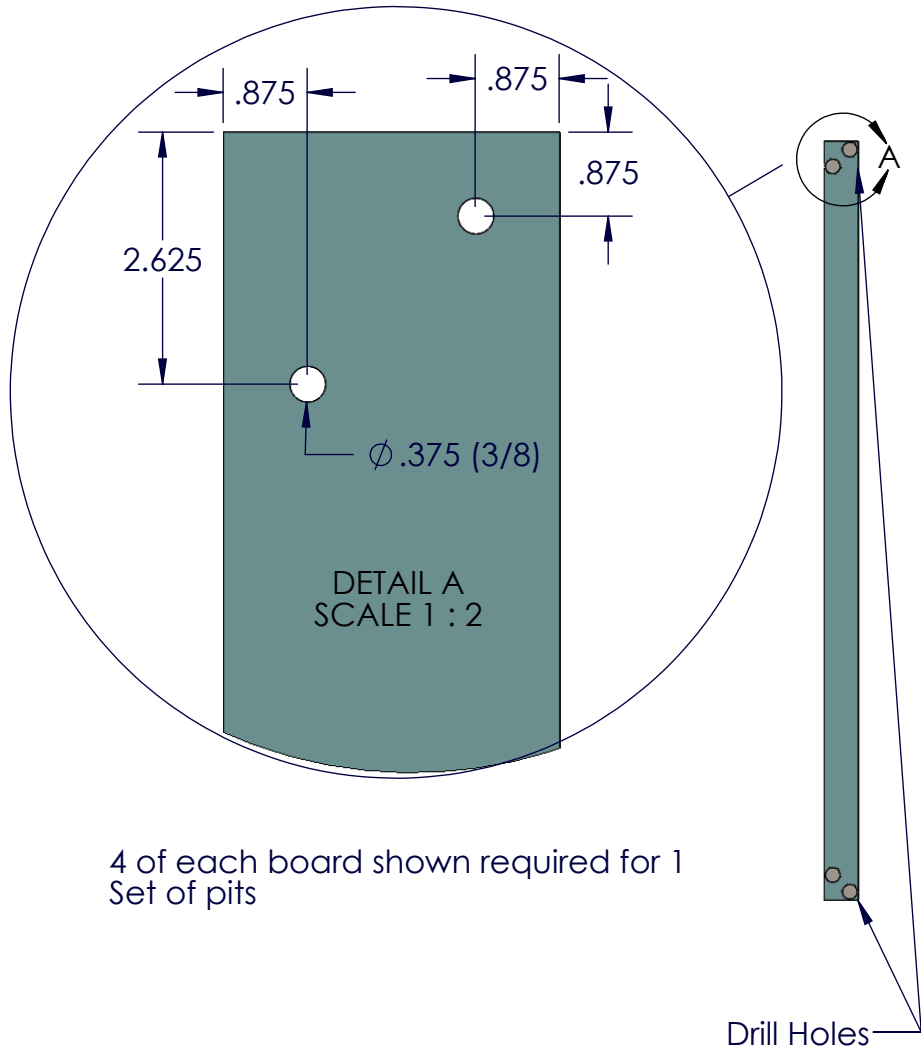

4 of each board shown required for 1 Set of pits

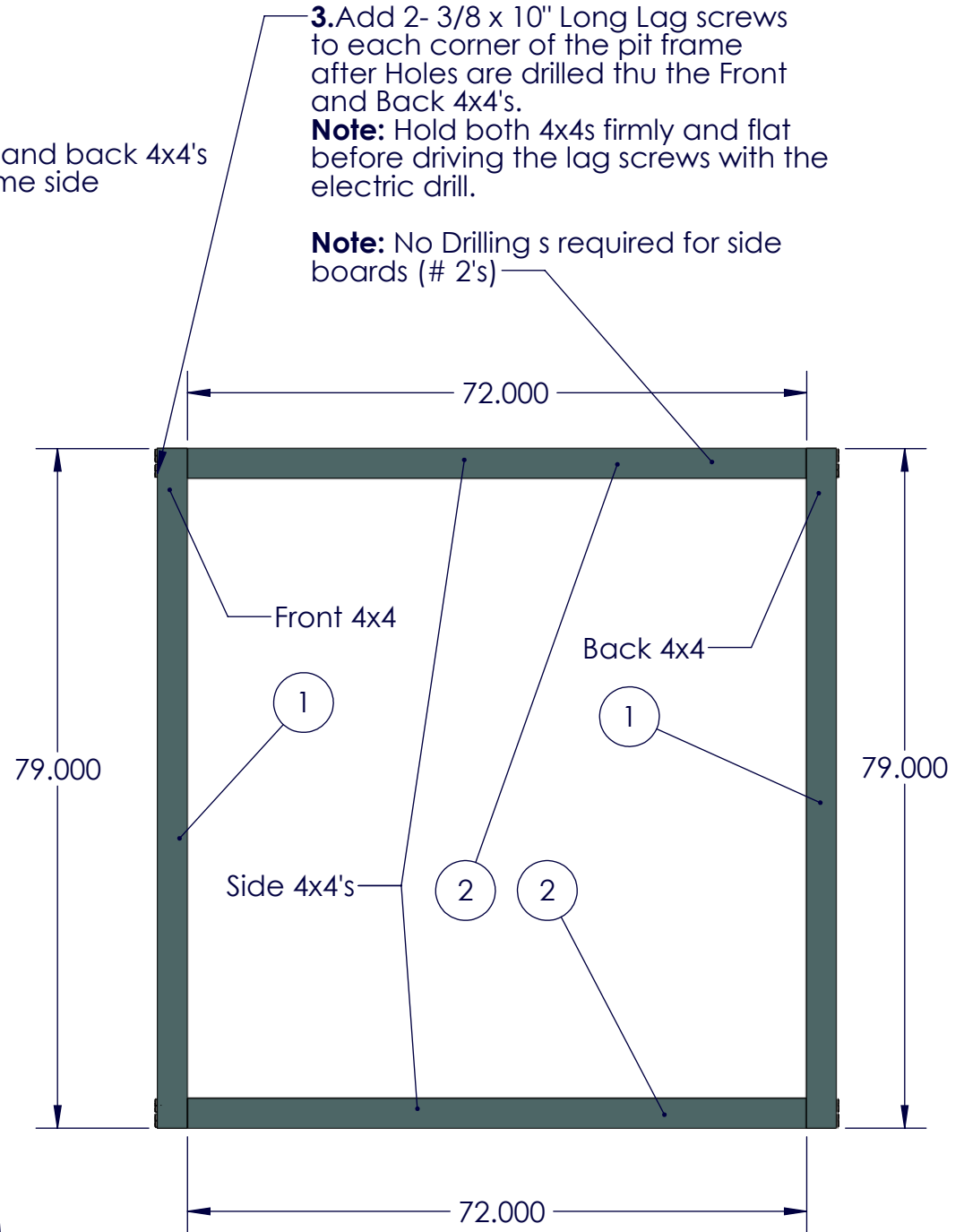

3. Add 2- 3/8 x 10" Long Lag screws to each corner of the pit frame after Holes are drilled thru the Front and Back 4x4's.

Note: Hold both 4x4s firmly and flat before driving the lag screws with the electric drill.

Note: No Drilling s required for side boards (# 2's)

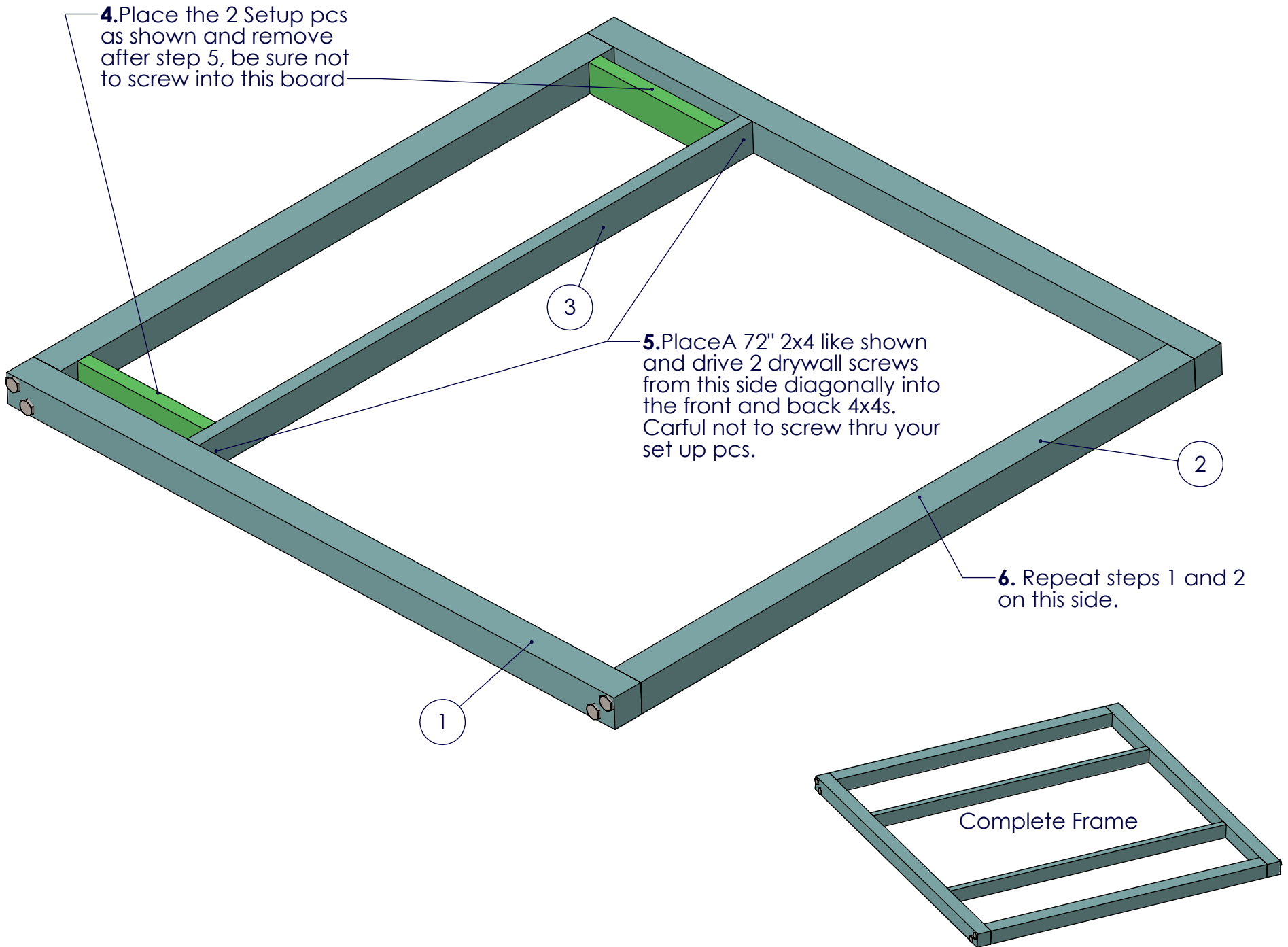

Stake Assembly

